

810/812 FORAGE MACHINE

5TH EDITION
STARTING WITH SERIAL NO. PFC81001001
OR PFC81201001

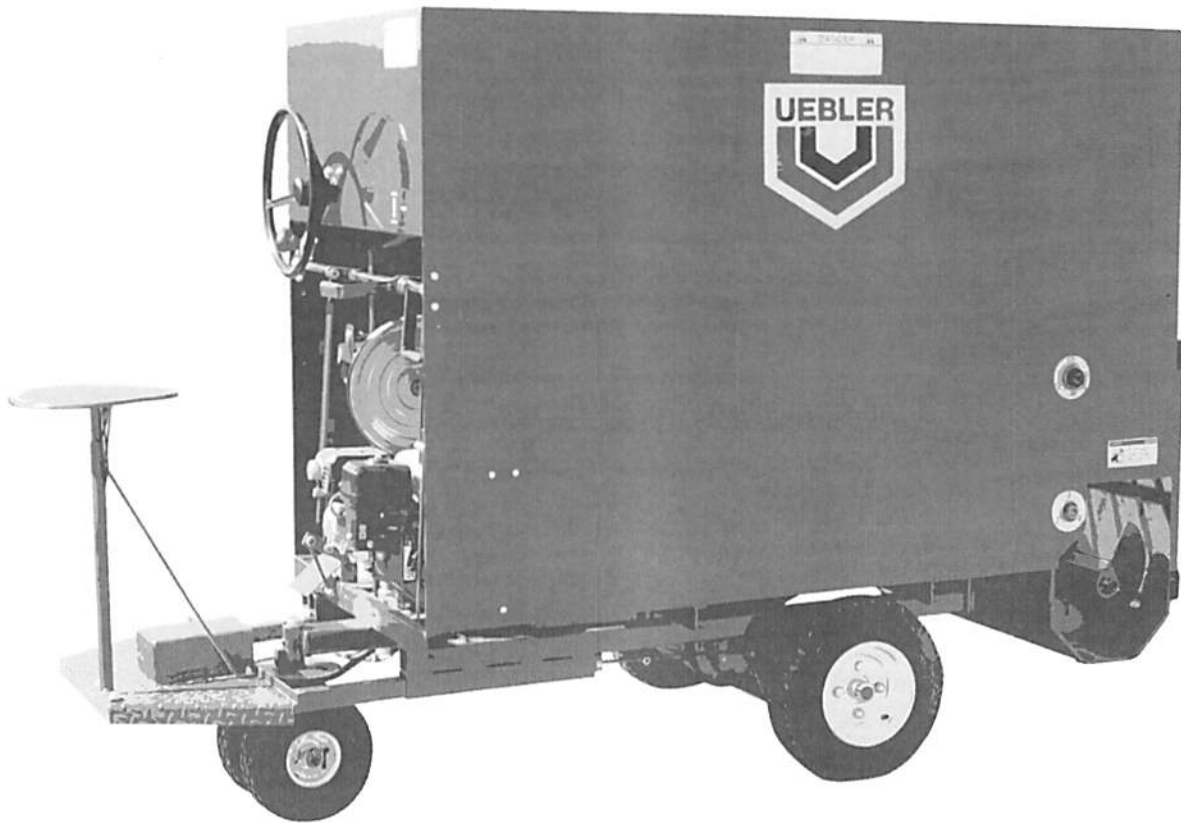

OWNER/OPERATOR AND PARTS MANUAL FOR:

**MODEL 810/812
GAS POWERED FORAGE MACHINE**



TABLE OF CONTENTS

	PAGE
TO THE OWNER/OPERATOR	1
GENERAL INFORMATION	2
SAFETY PRECAUTIONS.....	3
GENERAL INSTRUCTIONS.....	4
DECAL SHEET	5
PARTS LISTS.....	6-10
DIFFERENTIAL PARTS.....	11-12
LINKAGE AND BELTS.....	13
MAINTENANCE/WARRANTY	14

Note: To insure that the correct parts for your machine are ordered and shipped, please be sure to use the parts book and page that specifically covers your machine. Whenever in doubt include the serial number of your machine along with the parts numbers. For future reference insert serial number of your machine in the space below.

<p>Gruett's Inc.</p> <p>SERIAL NUMBER</p> <hr/> <p>GRUETT'S, INC. Potter, Wisconsin 54160 920-853-3516 · www.gruettsinc.com Made in the U.S.A.</p>

To the Owner/Operator:

Congratulations on the purchase of your new Uebler feeding machine.

Like all mechanical products, the useful life you obtain from your machine depends to a large extent on the way it is maintained and operated. Outlined in this instruction manual you will find safety and service hints to keep your machine operating like new for years to come.

We recommend that you read this instruction manual and the enclosed engine manual prior to the operation of this unit. Keep this booklet handy for all operators and servicemen.

Throughout this manual, the terms **IMPORTANT**, **CAUTION**, **WARNING** and **DANGER** are used to indicate the degree of hazard for the items of personal safety. These words will be used in conjunction with the Safety-Alert Symbol, a triangle with an exclamation mark.



The Safety-Alert Symbol means... **ATTENTION ! BECOME ALERT !
YOUR SAFETY IS INVOLVED !**



IMPORTANT Indicates that failure to observe can cause damage to equipment.



CAUTION Is used for general reminders of good safety practices, or to direct attention to unsafe practices.



WARNING Denotes a specific potential hazard.



DANGER Denotes the most serious specific potential hazard.

IMPORTANT: If safety or control decals are missing, non-legible, or damaged, they should be replaced as quickly as possible.

This manual applies to:
MODEL: 810/812 FEEDING MACHINE

GENERAL INFORMATION

USING THIS MANUAL

Illustrations used in this manual were current at the time of printing, but subsequent product changes may cause your machine to vary slightly in detail. Gruett's Inc. reserves the right to redesign and change the machine deemed necessary, without notification. If a change has been made to your machine which is not reflected in this owner's manual, or the illustrated parts list, see your Uebler dealer for current information and parts.

WARRANTY REGISTRATION

The delivery and warranty registration card must be completed and signed to validate your warranty protection. As the new equipment owner, you are expected to see that the card is completed and forwarded to Gruett's, Inc. at time of delivery.

IMPORTANT: Any unauthorized modification alteration or use of non-approved attachments voids the warranty and releases Gruett's, Inc. from any liability arising from subsequent use of this equipment.

MODEL AND SERIAL NUMBER

The serial number is found on the serial identification plate, located to the above right of the feed clutch handle.

This number is required on the Warranty Registration card. It will also assure you of the correct service parts when replacement becomes necessary.

PARTS AND SERVICE

Use original Uebler replacement parts only. These parts are available through your local Uebler equipment dealer. To obtain prompt efficient service, always provide the following information when ordering parts:

1. Correct part description and number, as given in the illustrated parts list supplied with your owner's packet.
2. Correct model number.
3. Correct serial number.

All warranty repair and service must be handled through an authorized Uebler dealer.

SAFETY PRECAUTIONS

1. Allow no children or unqualified persons to run equipment.
2. Keep all shields and guards in place, keep clear of drives and belts.
3. Do not operate machine in vicinity of other persons.
4. Never place any part of the body in the feed chamber with the engine running.
5. Know how to quickly stop the machine in case of an emergency.
6. Before leaving operators position:
 - A. Come to a complete stop.
 - B. Disengage main chain drive.
 - C. Slow throttle to an idle.
 - D. Turn ignition switch to the "OFF" position.
 - E. Wait for all movement to stop.
7. Remove spark plug wire before servicing.
8. Look to rear before backing up.
9. Decrease speed and be careful on uneven terrain and when turning.
10. Never drive across an incline always travel up and down, and never exceed a 5% grade.
11. Do not change the governor settings or overspeed the engine.
12. Check direction control and feed discharge control for proper movement with no binding before attempting to start engine or motor.
13. Make sure there is adequate ventilation wherever the machine is operated.



WHENEVER YOU SEE THIS SYMBOL IT MEANS:
ATTENTION !
BECOME ALERT.
YOUR SAFETY IS INVOLVED.

GENERAL INSTRUCTIONS

The Uebler 810 & 812 are self propelled Forage Machines powered by a 5.5 HP gas engine.

All functions of the machine are hand or foot controlled by the operator who rides at the control end of the machine.

The Ground Drive is driven from the engine to the self contained hydrostatic transmission, this transmission in turn is direct coupled to the differential. The 16" Dia. pneumatic tires & drive wheels attached directly to the axles of the differential.

One handle controls both forward & reverse motion, as well as ground speed.

The discharge is belt driven from the engine to a jackshaft. This jackshaft through a series of chain drives, powers the 12" auger, beater, and main conveyor.

One handle or foot pedal controls the discharge. This control must be held in position to operate the discharge drive. This mandates that the operator be present at the controls at all times. This is for your safety. **DO NOT ALTER THIS CONTROL IN ANY WAY!!!**

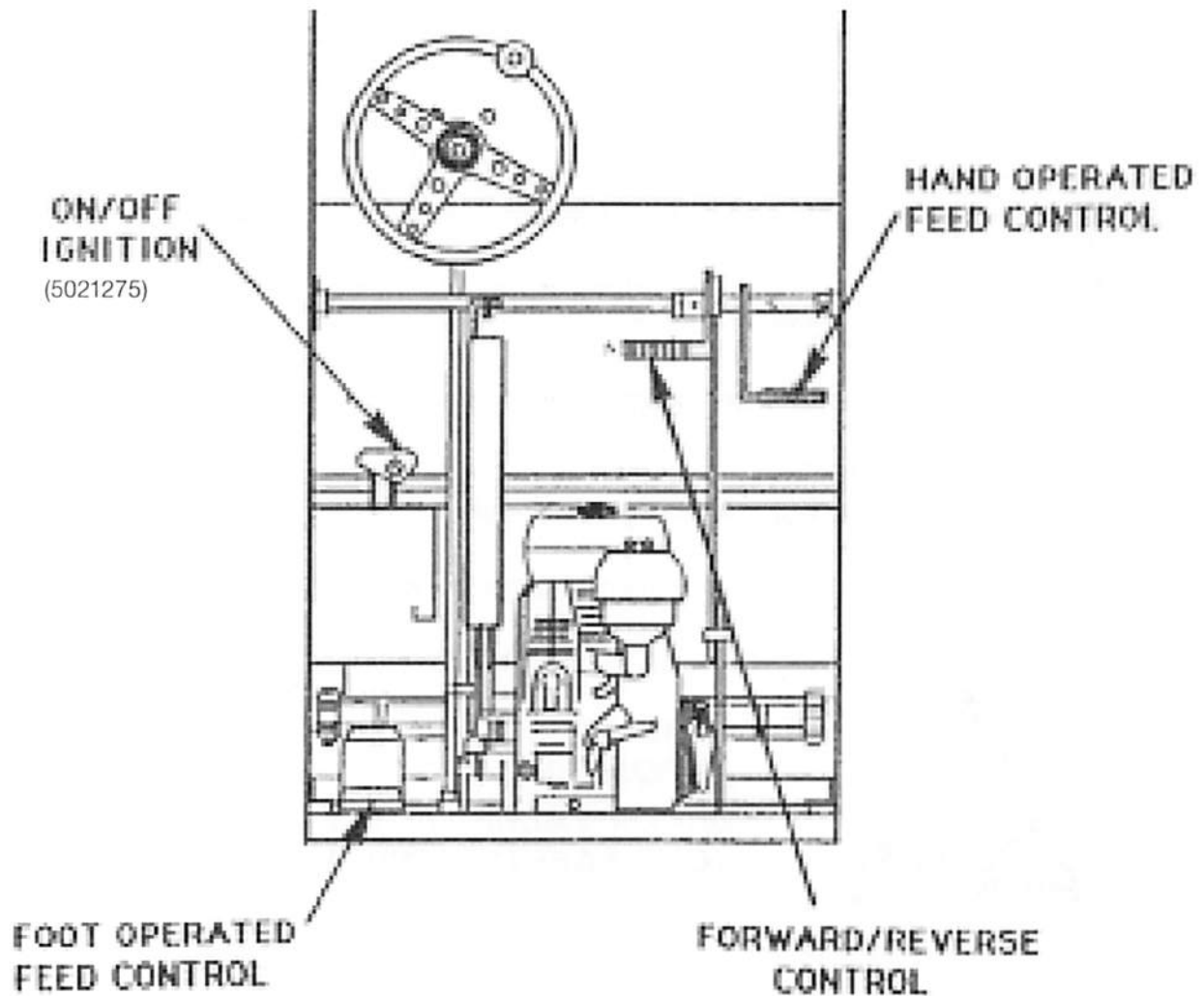

DECAL SHEET

ITEM	PART NO.	NO. REQ	DESCRIPTION
1	5051038	2	810
2	5051044	2	812
3	5020335	2	Uebler
4	5020337	1	Warning
5	5051034	1	Forward/Reverse + Feed
6	5021022	2	Danger
7	5021021	1	Warning

(1)

810

(2)

812

(5)

REVERSE



Feed

FORWARD

(3)



(4)

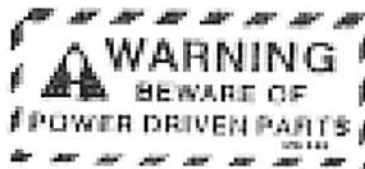

(6)



(7)



NOTE: When ordering Parts specify Part Number, Model Number, Serial Number.

810 Parts List

Item	Part No.	No. Req.	Description
1	5041037	1	Steering Wheel
2	5020107	1	Snap Ring
3	5020611	1	Steering Knob
4	5010558	1	37 G Gearbox
5	5030264	1	Main Box Weldment
6	5041447	1	Steering Shaft
7	5020595	2	1" Fafnir Bearing with Flange
8	5041440	1	Feed Drive Shaft
9	5020722	1	BS - 120 x 1" Pulley
10	5010036	3	1" Set Collar
11	5041444	1	Platform Weldment
12	5041045	1	Seat Pipe
13	5020006	1	Seat Spring
14	5041052	1	Seat Assembly
15	5020010	1	5/8 Bearing with Flange
16	5040962	1	40B15 x 5/8 Spk.
17	5040963	3	Beveled Idler Block
18	5040967	2	Idler Arm
19	5044125	1	Directional Wheel Mount
20	5020768	2	10" Directional Wheel Assembly
	5020775	2	10" Tire Only
	5020776	2	Tube Only
	5021042	2	Wheel Brg
	5021043	4	Ret.
	5020777	2	Rim
21	5020639	1	Extension Spring
22	5020604	2	16" Dia Wheel Ass'y
	5020702	2	Tire Only
	5020616	2	Rim
	5020615	2	Tube
23	5020603	2	4 Bolt Hub
24	5021095	2	SAS 1" Bearing
25	5020606	1	Hydrostatic Transmission
26	5042028	1	Differential
27	5020602	2	1" Single Split Collar
28	5021714	2	3/4" Aetna Bearing with Flange
29	5041152	1	Auger Shaft
30	5041159	2	Auger Weldment
31	5020595	2	1" Fafnir Bearing
32	5030272X810B	1	Auger Tray Liner

812 Parts List

Item	Part No.	No. Req.	Description
1	5041037	1	Steering Wheel
2	5020107	1	Snap Ring
3	5020611	1	Steering Knob
4	5010558	1	37 G Gearbox
5	5030284-812	1	Main Box Weldment
6	5041447	1	Steering Shaft
7	5020595	2	1" Fafnir Bearing with Flange
8	5041440-812	1	Feed Drive Shaft
9	5020722	1	BS - 120 x 1" Pulley
10	5010036	3	1" Set Collar
11	5041444-812	1	Platform Weldment
12	5041045	1	Seat Pipe
13	5020006	1	Seat Spring
14	5041052	1	Seat Assembly
15	5020010	1	5/8 Bearing with Flange
16	5040962	1	40B15 x 5/8 Spk.
17	5040963	3	Beveled Idler Block
18	5040967	2	Idler Arm
19	5044125	1	Directional Wheel Mount
20	5020768	2	10" Directional Wheel Assembly
	5020775	2	10" Tire Only
	5020776	2	Tube Only
	5021042	2	Wheel Brg
	5021043	4	Ret.
	5020777	2	Rim
21	5020639	1	Extension Spring
22	5020604	2	16" Dia Wheel Ass'y
	5020702	2	Tire Only
	5020716	2	Rim
	5020715	2	Tube
23	5020603	2	4 Bolt Hub
24	5021095	3	SAS 1" Bearing
25	5020606	1	Hydrostatic Transmission
26	5041277	1	Differential
27	5020602	2	1" Single Split Collar
28	5021714	2	3/4" Aetna Bearing with Flange
29	5041152-812	1	Auger Shaft
30	5041159-812	1	Auger Weldment
31	5020595	2	1" Fafnir Bearing with Flange
32	5030272X812B	1	Auger Tray Liner

NOTE: When ordering Parts specify Part Number, Model Number, Serial Number.

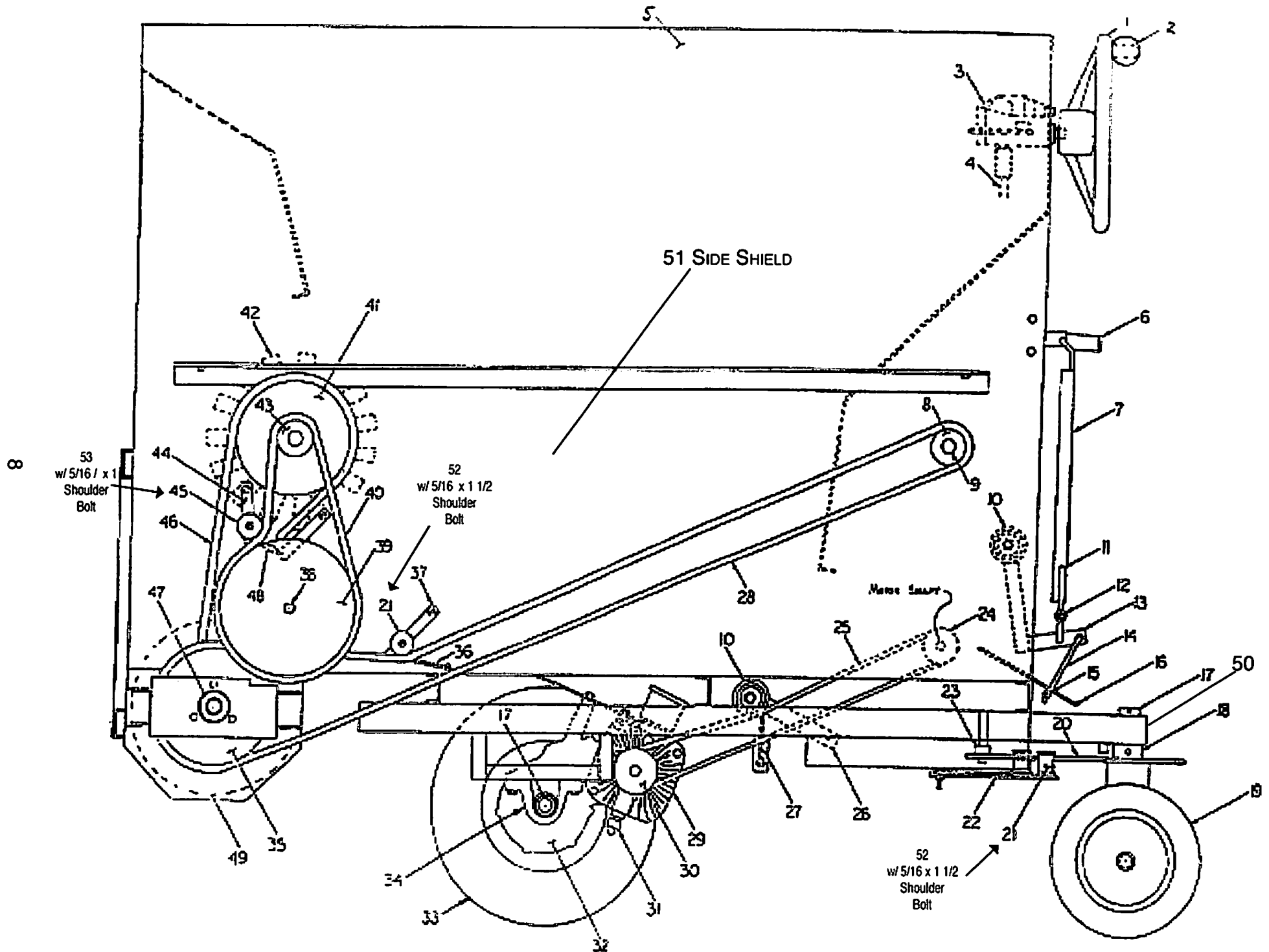

NOTE: When ordering Parts specify Part Number, Model Number, Serial Number.

810 Parts List

812 Parts List

Item	Part No.	No. Req.	Description
1	5041037	1	Steering Wheel
2	5020611	1	Steering Knob
3	5010558	1	37 G Gearbox
4	5041447	1	Steering Shaft
5	5030284	1	Main Box Weldment
6	5042290	1	Control Handle Weldment
7	5042293	1	Feed Linkage Weldment
8	5020729	1	40 B 14 x 1" Spk.
9	5041440	1	Feed Drive Shaft
10	5010318	2	Idler Pulley
11	5041030	1	Feed Linkage Lower
12	5040961	3	Linkage Adjuster
13	5041007	1	Idler Arm Weldment
14	5041449	1	Foot Pedal Linkage
15	5010583	1	5/16 Rod End Connector
16	5041463	1	Foot Pedal Weldment
17	5010036	3	1" Set Collar
18	5044125	1	Directional Wheel Mount
19	5020768	2	10" Directional Wheel Ass'y
	5020775	2	10" Tire Only
	5020776	2	Tube Only
	5021042	2	Wheel Brg
	5021043	4	Ret.
	5020777	2	Rim
20	5010673-79	1	#40 Roller Chain 79 Links
21	5040975	3	Beveled Idler Block
22	5040967	2	Idler Arm
23	5040962	1	40B15 x 5/8 Spk.
24	5020598	1	BK-25 x 3/4 Pulley
25	5020707	1	SL 590 Belt
26	5041156	1	Idler Arm
27	5020638	1	Draw Bar Spring
28	5010673-252	1	#40 Roller Chain 252 Links
29	5020606	1	Hydrostatic Transmission
30	5040965	1	BS-30 x 17mm Bore Spk.
31	5041438	1	Direction Lever
32	5042028	1	Differential
33	5020604	2	16" Dia Wheel Assembly
	5020702	2	Tire Only
	5020616	2	Rim Only
	5020615	2	Tube Only
34	5021095	2	SAS 1" Bearing
35	5040957	1	40A 48-15 x 1" Combination Spk.
36	5020639	1	Extension Spring
37	5040947	1	Idler Arm
38	5041024	1	Main Conveyor Shaft
39	5040960	1	40 B 60 3/4" Spk.
40	5010673-86	1	#40 Roller Chain 86 Links
41	5041090	1	40 B 48 x 1" Spk.
42	5041089	1	Beater
43	5040956	1	40 B 15 x 1" Spk.
44	5040947	2	Idler Arm
45	5040964	2	Idler Block Only
46	5010673-108	1	#40 Roller Chain 108 Links
47	5020595-1	2	1" Fafnir Bearing with Flange
48	5010213	1	Spring
49	5041159	1	Auger Weldment
50	5020054	2	Brass Bushing
51	5041038	1	Side Shield
52	5042390	3	S Bolt 5/16x1 1/2
53	5042391	2	S Bolt 5/16 x1

Item	Part No.	No. Req.	Description
1	5041037	1	Steering Wheel
2	5020611	1	Steering Knob
3	5010558	1	37 G Gearbox
4	5041447	1	Steering Shaft
5	5030284-812	1	Main Box Weldment
6	5042290-812	1	Control Handle Weldment
7	5042293	1	Feed Linkage Weldment
8	5020729	1	40 B 14 x 1" Spk.
9	5041440-812	1	Feed Drive Shaft
10	5010318	1	Idler Pulley
11	5041030	1	Feed Linkage Lower
12	5040961	3	Linkage Adjuster
13	5041007	1	Idler Arm Weldment
14	5041449	1	Foot Pedal Linkage
15	5010583	1	5/16 Rod End Connector
16	5041463	1	Foot Pedal Weldment
17	5010036	3	1" Set Collar
18	5041441	1	Directional Wheel Mount
19	5020768	2	10" Directional Wheel Ass'y
	5020775	2	10" Tire Only
	5020776	2	Tube Only
	5021042	2	Wheel Brg
	5021043	4	Ret.
	5020777	2	Rim
20	5010673-86	1	#40 Roller Chain 86 Links
21	5040963	3	Beveled Idler Block
22	5040967	2	Idler Arm
23	5040962	1	40B 15 x 5/8 Spk.
24	5020598	1	BK-25 x 3/4 Pulley
25	5020727	1	SL 640 Belt
26	5041156	1	Idler Arm
27	5020638	1	Draw Bar Spring
28	5010673-276	1	#40 Roller Chain 276 Links
29	5020606	1	Hydrostatic Transmission
30	5040965	1	BS-30 x 17mm Bore Spk.
31	5041438	1	Direction Lever
32	5041277	1	Differential
33	5020604	2	16" Dia Wheel Assembly
	5020702	2	Tire Only
	5020616	2	Rim Only
	5020615	2	Tube Only
34	5021095	3	SAS 1" Bearing
35	5040957	1	40A 48-15 x 1" Combination Spk.
36	5020639	1	Extension Spring
37	5040947	1	Idler Arm
38	5041024-812	1	Main Conveyor Shaft
39	5040960	1	40 B 60 3/4" Spk.
40	5010673-86	1	#40 Roller Chain 86 Links
41	5041090	1	40 B 48 x 1" Spk.
42	5041089-812	2	Beater
43	5040956	1	40 B 15 x 1" Spk.
44	5040947	2	Idler Arm
45	5040964	2	Idler Block Only
46	5010673-112	1	#40 Roller Chain 112 Links
47	5020595	2	1" Fafnir Bearing with Flange
48	5010213	1	Spring
49	5041159-812	1	Auger Weldment
50	5020054	2	Brass Bushing
51	5041038-812	1	Side Shield
52	5042390	3	S Bolt 5/16 x 1 1/2
53	5042391	2	S Bolt 5/16 x 1

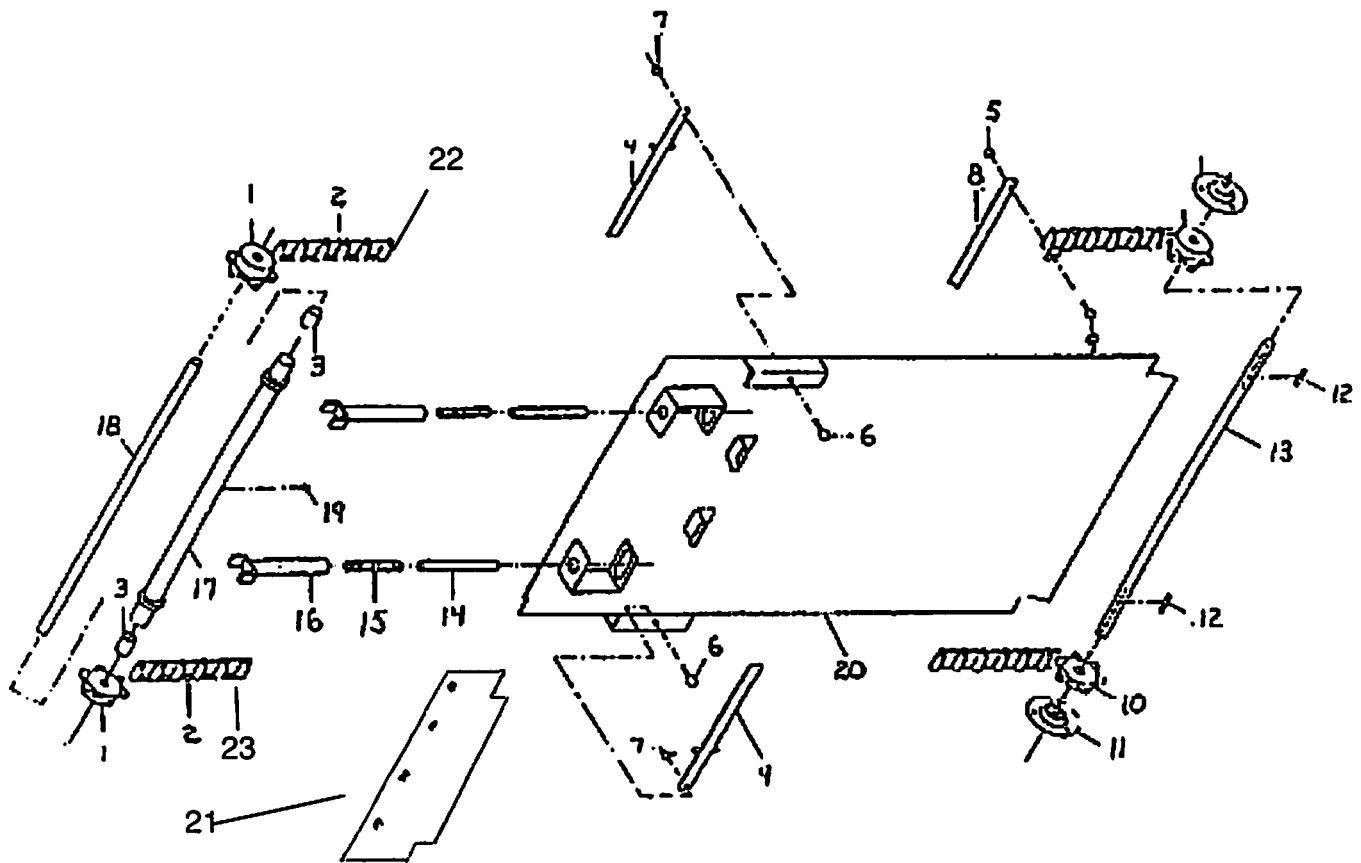

MAIN CONVEYOR FLOOR ASSEMBLY

810 Parts List

Item	Part No.	No. Req.	Description
1	5010286	2	Idler Spk.
2	5020778	1	Main Conveyor Chain (1 set)
3	5023344	2	3/4" 10 x 1" OD Bushing
4	5040779	2	Lever
5	5025043	24	1/4" - 20 Top Loc Nut
6	5025001-5	2	5/16" - 18 Bolt 5/8" Long
7	5025042	2	5/16" - 18 Top Loc Nut
8	5041001	12	Main conveyor Slat
9	5025010-4	24	1/4" - 20 Bolt 1/2" Long
10	5010285	2	FT4 Drive Spk.
11	5021714	2	3/4" Aetna Bearing
12	5050403-2	2	3/16" Sq Key 1 1/2" Long
13	5041024	1	Main Conv. Shaft
14	5050702-6	2	3/8" ID Pipe 5 3/4" Long
15	5020006	2	Spring
16	5041450	2	Tightener Push Rod
17	5040998	1	Idler Shaft Housing Ass'y
18	5050501-5	1	Idler Shaft 3/4" Dia Crs 28 3/8"
19	5020095	1	Straight Grease Fitting
20	5030282	1	Main Conveyor Floor Weldment
	5030282 Liner	1	Floor Liner (not shown)
21	5040895	1	Rubber Flap
22	5010193	1	RH Attach Link
23	5010194	1	LH Attach Link

812 Parts List

Item	Part No.	No. Req.	Description
1	5010286	2	Idler Spk.
2	5020779	1	Main Conveyor Chain (1 set)
3	5023344	2	3/4" 10 x 1" OD Bushing
4	5040779	2	Lever
5	5025043	26	1/4" - 20 Top Loc Nut
6	5025001-5	2	5/16" - 18 Bolt 5/8" Long
7	5025042	2	5/16" - 18 Top Loc Nut
8	5041236	13	Main conveyor Slat
9	5025010-4	26	1/4" - 20 Bolt 1/2" Long
10	5010285	2	FT4 Drive Spk.
11	5021714	2	3/4" Aetna Bearing
12	5050403-2	2	3/16" Sq Key 1 1/2" Long
13	5041024-812	1	Main Conv. Shaft
14	5050702-6	2	3/8" ID Pipe 5 3/4" Long
15	5020006	2	Spring
16	5041450	2	Tightener Push Rod
17	5040998-812	1	Idler Shaft Housing Ass'y
18	5050501-13	1	Idler Shaft 3/4" Dia Crs 33 3/8"
19	5020095	1	Straight Grease Fitting
20	5030282-812	1	Main Conveyor Floor Weldment
	5030282-812 Liner	1	Floor Liner (not shown)
21	5042598	1	Rubber Flap
22	5010193	1	RH Attach Link
23	5010194	1	LH Attach Link

DIFFERENTIAL ASSEMBLY

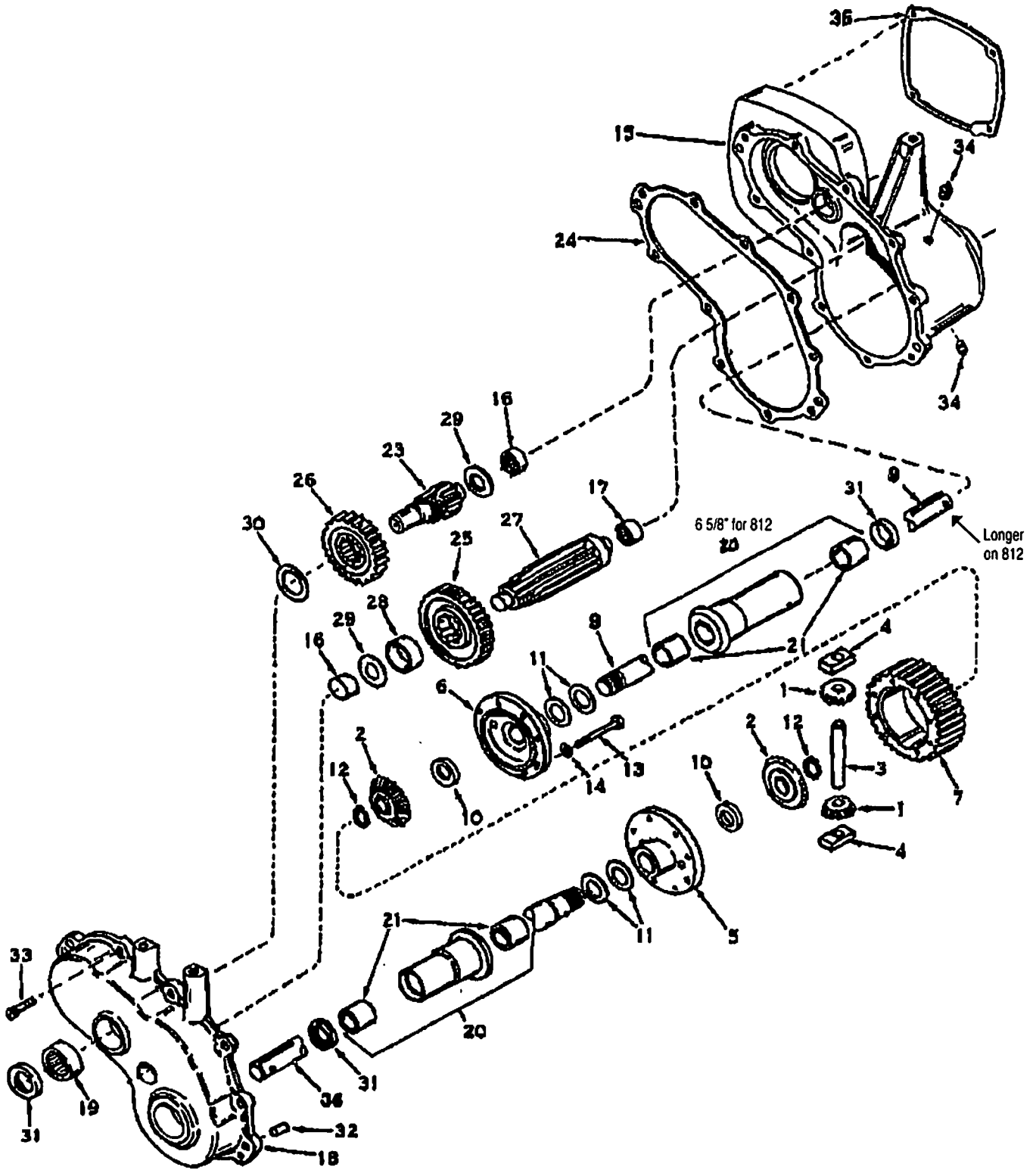

DIFFERENTIAL

Item	Part No.	No. Req.	Description
1	50209741	2	Gear, Bevel Pinion
2	50209742	2	Gear, Bevel
3	50209743	1	Pin, Drive
4	50209744	2	Block, Drive
5	50209745	1	Carrier, Differential
6	50209746	1	Carrier, Differential
7	50209747	1	Gear, Ring
8	5020974X8	2	810 Axle (19-1/8" Long)
9	5020692	1	812 Long Axle (24" Long)
10	502097410	2	Washer
11	5020261	4	Washer, Thrust
12	5020262	2	Ring, Snap
13	502097413	8	Screw, 1/4 - 20 x 2-1/4
14	502097414	8	Lockwasher, 1/4"
15	5021009	1	Case Assy. (Incl. #16 & 17)
16	502097416	2	Bearing Needle
17	502097417	1	Bearing Needle
18	5020769	1	Cover Assy. (Incl., #16 & 17)
19	5020974	1	Bearing Needle
20	5021008	2	Housing Assy., (810) (Incl. 2 of 21) (4-21/32" Long)
	5021008812		6 5/8" Axle Housing (812)
21	502097421	4	Bushing
23	502097423	1	Shaft, Brake
24	5020696	1	Gasket, Case-to-Cover
25	5020277	1	Gear, Output
26	502097426	1	Gear, Idler
27	502097427	1	Shaft, Output
28	502097428	1	Spacer
29	502097429	2	Washer
30	502097430	1	Washer
31	5020285	3	Seal, Oil
32	502097432	2	Pin, Dowel
33	502097433	10	Screw, Hex Head 1/4 x 1
34	5020292	2	Plug Pipe
35	5020600	1	Gasket
36	5042032	1	13 1/8" Short Axle (812 & 810)
37	5042028	1	810 Complete Assembly
38	5041277	1	812 Complete Assembly

LINKAGES & BELTS

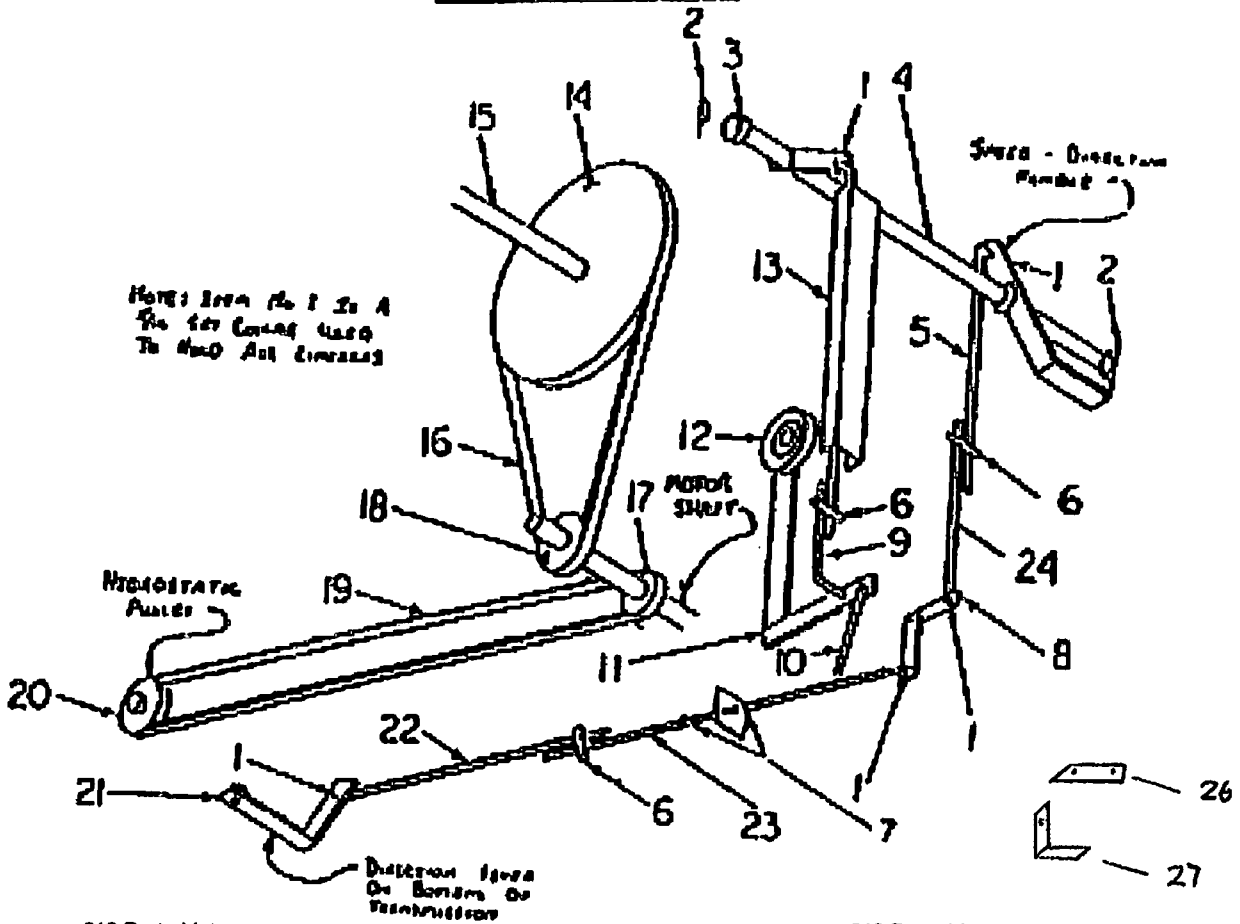

810 Parts List

812 Parts List

Item	Part No.	No. Req.	Description
1	5020047	9	5/16" Set Collar
2	5021098	2	3/4" Triangle Bearing
3	5010116	1	3/4" Set Collar
4	5042290	1	Control Handle Weldment
5	5041029	1	Drive Linkage Lower
6	5040961	3	Linkage Adjuster
7	5020637	2	Compression Spring
8	5041010	1	Bellcrank
9	5041030	1	Feed Linkage Lower
10	5041449	1	Foot Pedal Linkage
11	5041007	1	Idler Arm Weldment
12	5010318	1	Idler Pulley
13	5042293	1	Feed Linkage Guard
14	5020722	1	BS-120 Pulley
15	5041440	1	Feed Drive Shaft
16	5020771	1	6953 Green Belt
17	5020598	1	BK-25 x 3/4" Pulley
18	5010217	1	BS-32 x 3/4" Pulley
19	5020707	1	SL 590 Belt
20	5040965	1	BS-30 x 17mm Bore Pulley
21	5041438	1	Direction Lever
22	5041448	1	Drive Linkage Lower
23	5041027	1	Drive Linkage Lower
	5020597	1	Honda Engine (NOT SHOWN) 5.5HP
	5020772	4	Rubber Mount (NOT SHOWN)
24	5041028	1	Drive Linkage Upper
25	5041436	1	Engine Plate (NOT SHOWN)
26	5045361	1	Belt Keep
27	5041035	1	Belt Slip
28	5046934	2	Engine Spacer (NOT SHOWN)

Item	Part No.	No. Req.	Description
1	5020047	9	5/16" Set Collar
2	5021098	2	3/4" Triangle Bearing
3	5010116	1	3/4" Set Collar
4	5042290-812	1	Control Handle Weldment
5	5041029	1	Drive Linkage Lower
6	5040961	3	Linkage Adjuster
7	5020637	2	Compression Spring
8	5041010	1	Bellcrank
9	5041030	1	Feed Linkage Lower
10	5041449	1	Foot Pedal Linkage
11	5041007	1	Idler Arm Weldment
12	5010318	1	Idler Pulley
13	5042293-812	1	Feed Linkage Guard
14	5020722	1	BS-120 Pulley
15	5041440-812	1	Feed Drive Shaft
16	5020771	1	6953 Green Belt
17	5020598	1	BK-25 x 3/4" Pulley
18	5010217	1	BS-32 x 3/4" Pulley
19	5020727	1	SL 640 Belt
20	5040965	1	BS-30 x 17mm Bore Pulley
21	5041438	1	Direction Lever
22	5041448	1	Drive Linkage Lower
23	5041027	1	Drive Linkage Lower
	5020597	1	Honda Engine (NOT SHOWN) 5.5HP
	5020772	4	Rubber Mount (NOT SHOWN)
24	5041028	1	Drive Linkage Upper
25	5041436	1	Engine Plate (NOT SHOWN)
26	5045361	1	Belt Keep
27	5041035	1	Belt Slip
28	5046934	2	Engine Spacer (NOT SHOWN)

MAINTENANCE AND ADJUSTMENT CHECKLIST

DESCRIPTION	WEEKLY	MONTHLY
LUBRICATION (OIL)		
Roller Chains (remove side guards)	X	
Roller Chain (directional wheel mount)	X	
Hydrostatic transmission (20 wt. Oil) Check when cold, level should reach marks on side of Oil reservoir marked "COLD"		X
Engine - See Engine Manual		X
Differential Assy 80-90w Oil		X
LUBRICATION (GREASE)		
Differential Mount Bearings		X
Directional Wheel Mount		X
Main Conv. Idler Housing (Behind Engine)		X
Directional Wheels (2 places)		X
ADJUSTMENTS		
Set screw - Tighten on all set collars, pulleys, bearings and sprockets		X
Drive Wheels - Tighten lug nuts		X
Tires - 70 P.S.I.		X

WARRANTY

UEBLER DIV OF GRUETT'S, INC.

MODEL 810, 812 FORAGE MACHINE LIMITED WARRANTY

This warranty shall apply only if the enclosed registry has been completed and returned to Uebler's within Ten days from the date of delivery.

Uebler of Gruett's, Inc. warrants to the original purchaser for the period of one year from the date of purchase of a Uebler Forage Machine any part or parts found under examination by the factory at Potter, WI or by factory authorized personnel to be defective in material or workmanship under normal use. All transportation charges on parts submitted for replacement under this warranty must be borne by the purchaser.

This warranty does not apply to belts, batteries, engine, electrical and electronic components which carry their individual manufacturer's guarantees.

This warranty and Uebler's obligation hereunder is in lieu of all other warranties, expressed or implied, including without limitation, the implied warranty of merchantability or implied warranty of fitness for particular purpose, and all other obligation or liabilities of Uebler for incidental and consequential damages resulting from the design, manufacture, sale or use of the machine. No person is authorized to make any warranty or assume for Uebler any liability not strictly in accordance with this warranty.

This warranty shall not apply to any machine or machine part which, in the judgement of Uebler's has been altered or tampered with in any way or has been subjected to misuse, neglect or accident, or has had the serial numbers altered, effaced or removed.